

AUFLAGESEITE

SENKRECHTER SCHNITT oben

Kunde		ZUANI DEUTSCHLAND rif. PAULI			
Title		Fensterschnitt IV 68/68 - Eurofalz Achsmass 13 mm			
Revis.	A.P.	Date	15-05-2012	Scala	1:1
Verif.	M.Z.	Date	12-12-2011	Dis.	M.Z.
				Codice Dis.N°	A6868D22.256
				Date	12-12-2011

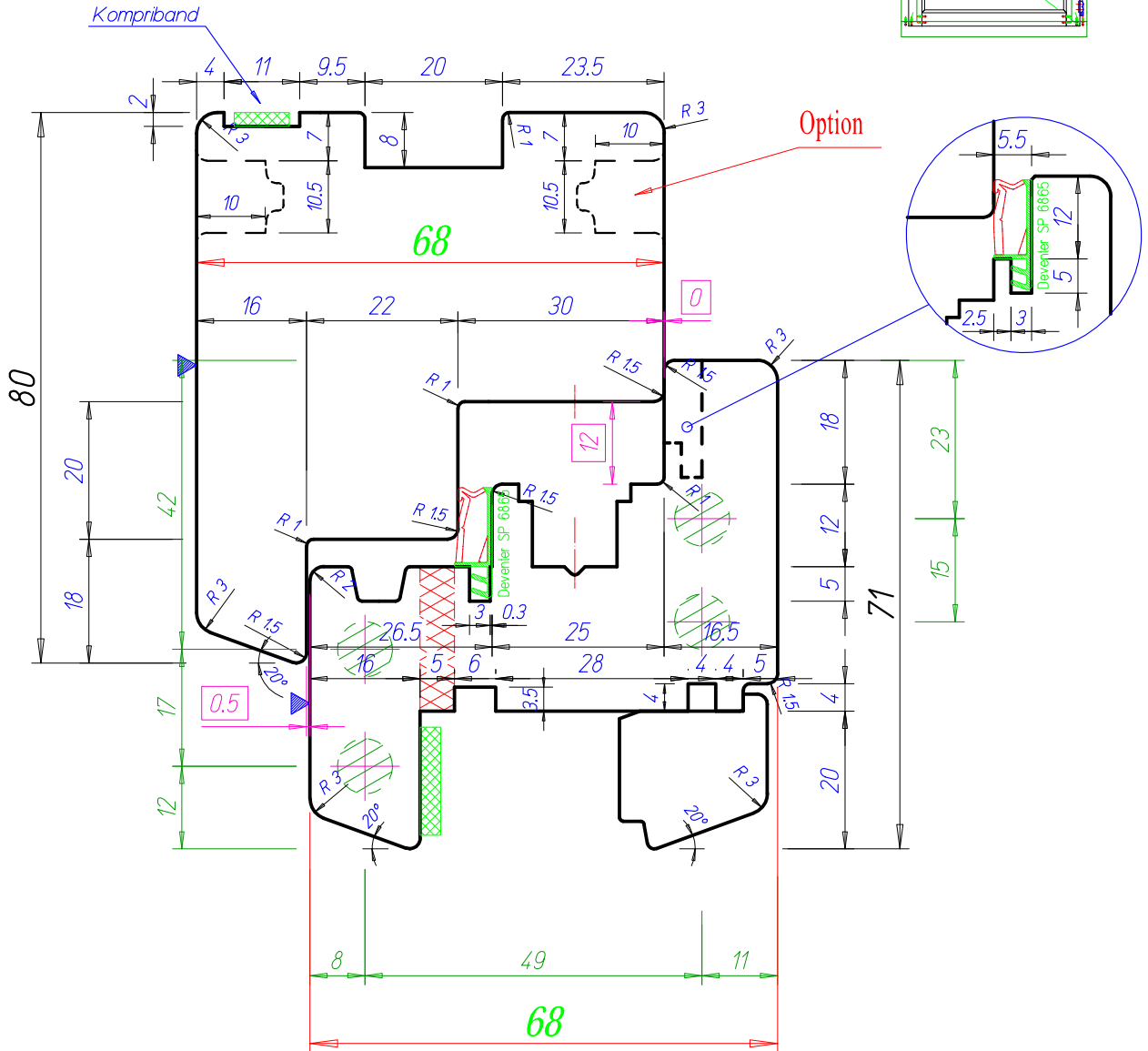
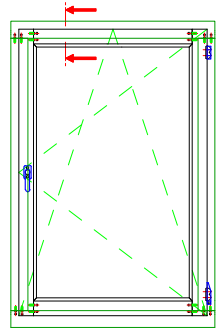

AUFLAGESEITE

SENKRECHTER SCHNITT oben

Kunde		ZUANI DEUTSCHLAND rif. PAULI			
Title		Fensterschnitt IV 68/68 - Eurofalz Achsmass 13 mm			
Revis.	A.P.	Date	15-05-2012	Scala	1:1
Verif.	M.Z.	Date	12-12-2011	Dis.	M.Z.
				Date	12-12-2011
				Codice Dis.N°	A6868D22.256

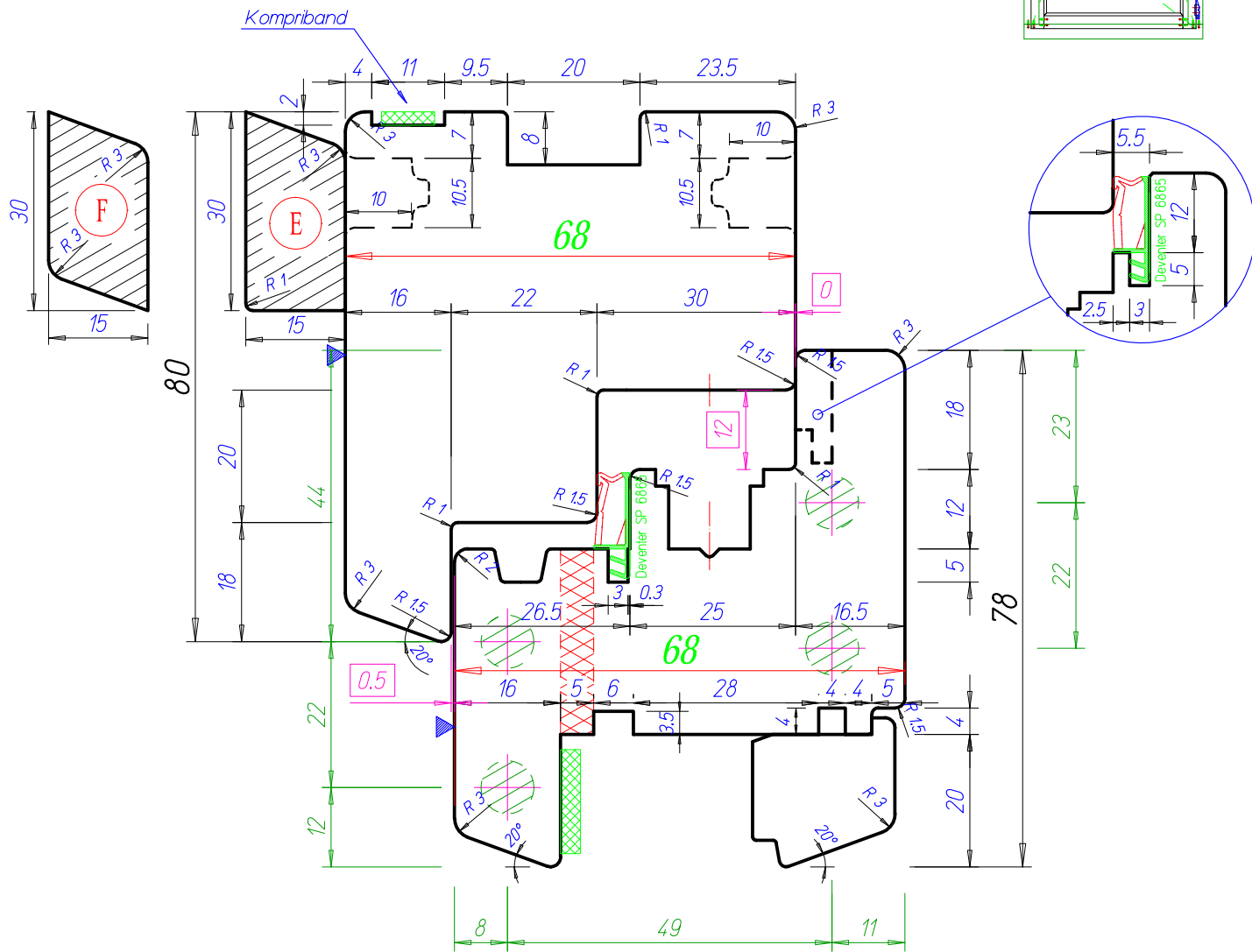

AUFLAGESEITE

SENKRECHTER SCHNITT oben

Kunde		ZUANI DEUTSCHLAND rif. PAULI			
Title		Fensterschnitt IV 68/68 - Eurofalz Achsmass 13 mm			
Revis.	A.P.	Date	15-05-2012	Scala	1:1
Verif.	M.Z.	Date	12-12-2011	Dis.	M.Z.
		Date	12-12-2011	Codice Dis.N°	A6868D22.256

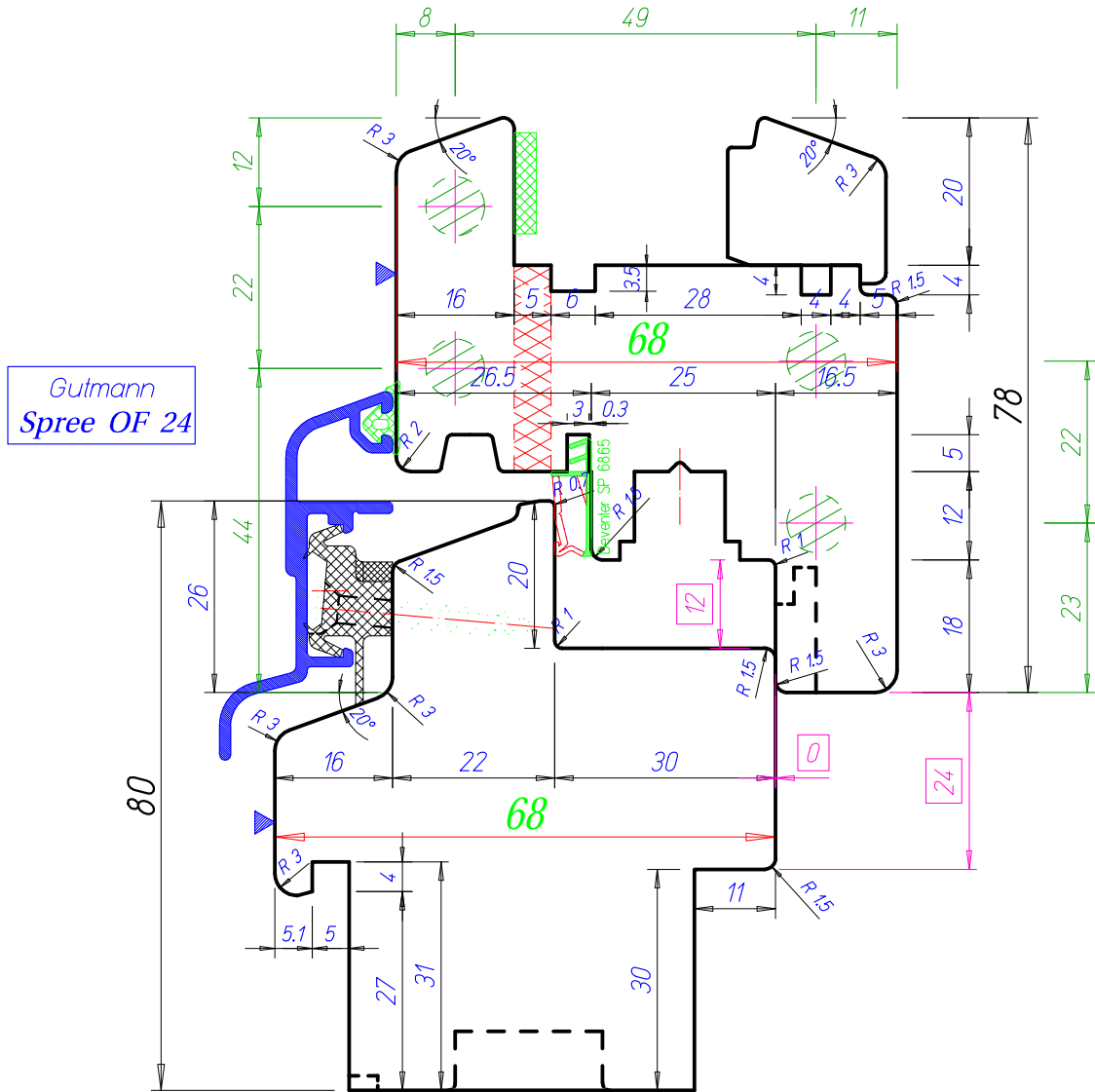
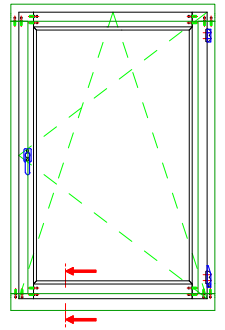

Gutmann
Spree OF 24

 AUFLAGESEITE

SENKRECHTER SCHNITT unten

Kunde		ZUANI DEUTSCHLAND rif. PAULI			
Title		Fensterschnitt IV 68/68 - Eurofalz Achsmass 13 mm			
Revis.	A.P.	Date	15-05-2012	Scala	1:1
Verif.	M.Z.	Date	12-12-2011	Dis.	M.Z.
		Date	12-12-2011	Codice	A6868D22.256
				Dis.N°	A6868D22.256

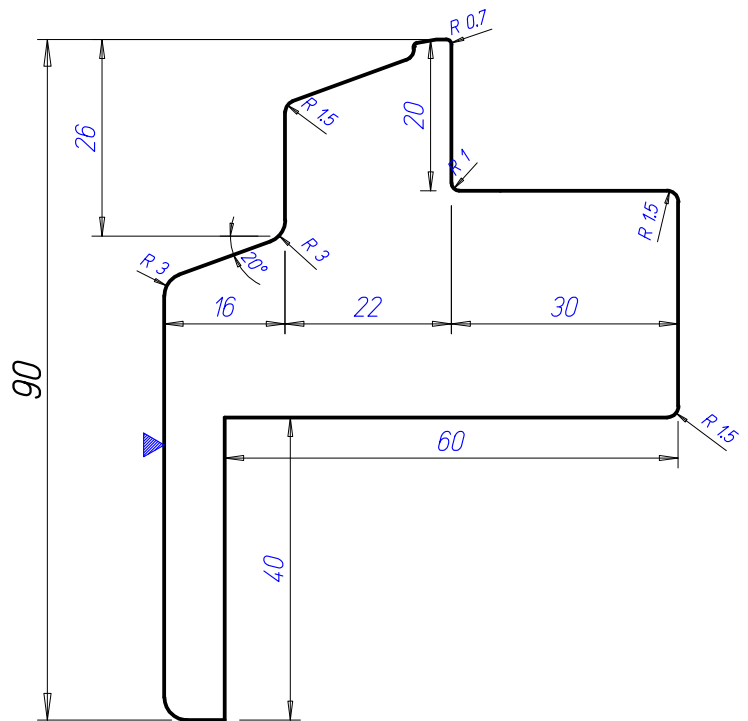
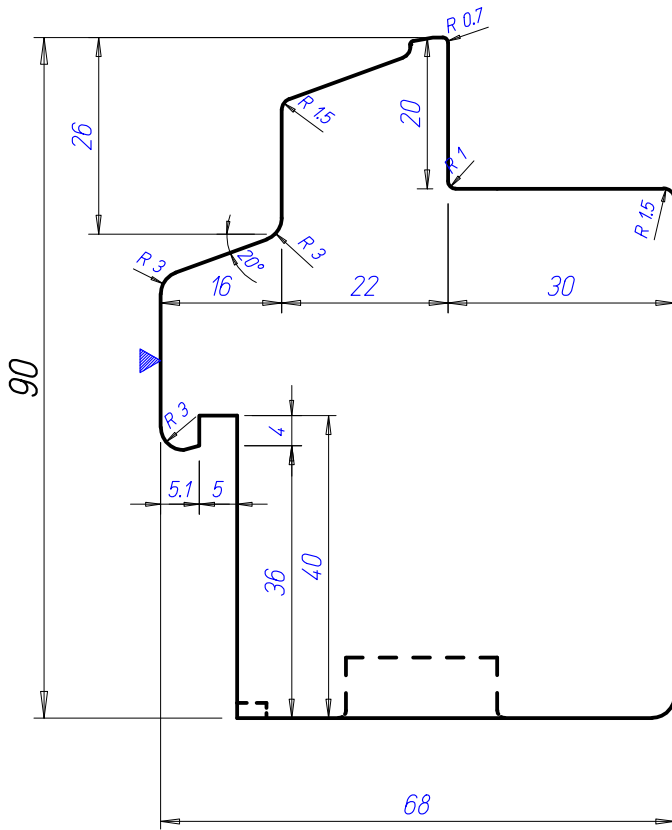
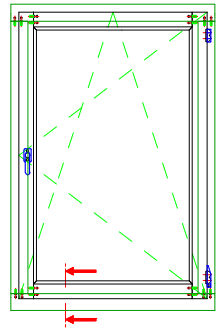

 AUFLAGESEITE

SENKRECHTER SCHNITT unten

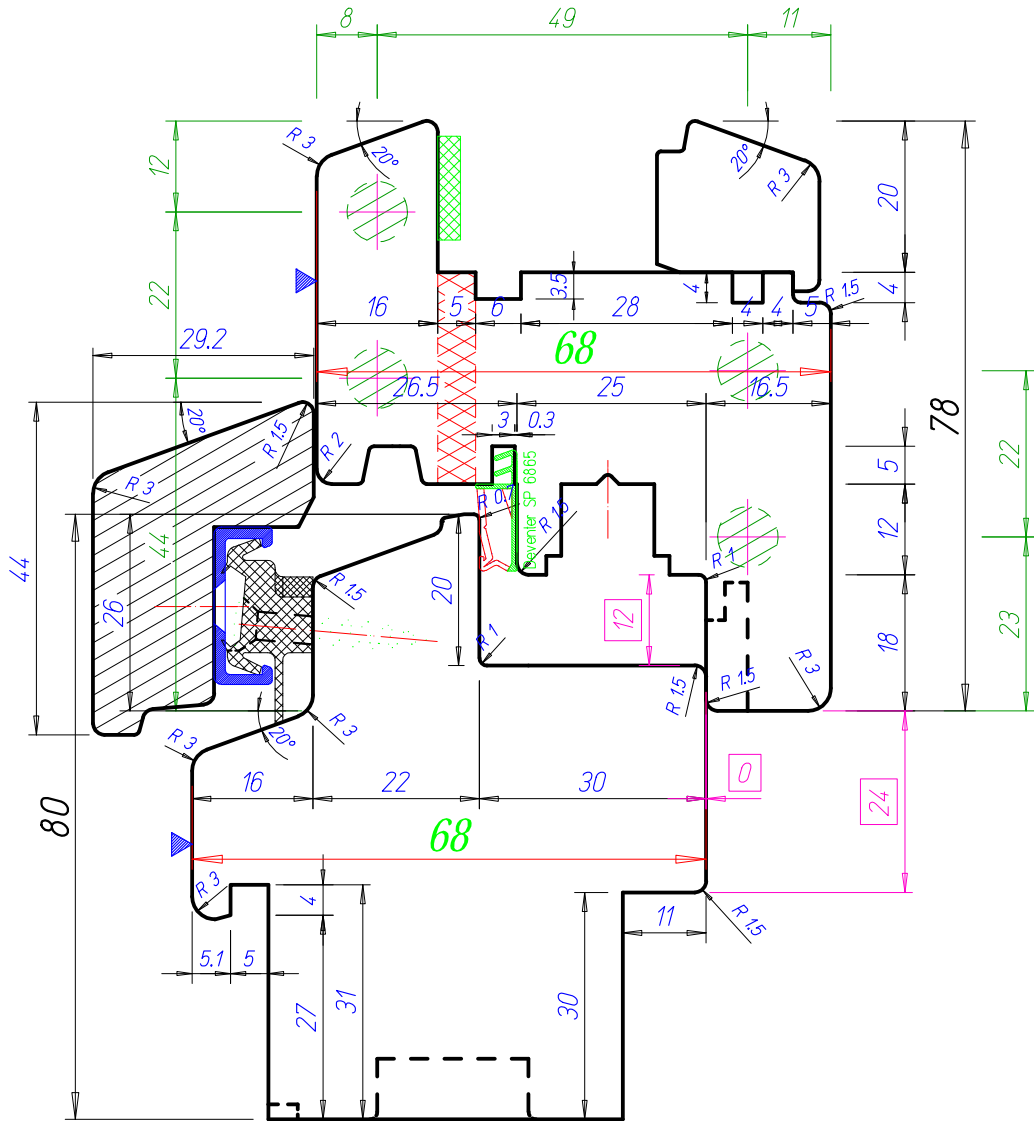
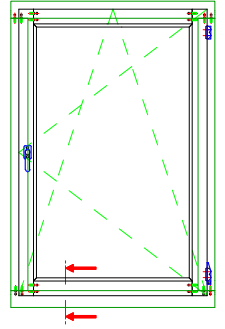

 AUFLAGESEITE

SENKRECHTER SCHNITT unten

Kunde		ZUANI DEUTSCHLAND rif. PAULI			
Title		Fensterschnitt IV 68/68 - Eurofalz Achsmass 13 mm			
Revis.	A.P.	Date	15-05-2012	Scala	1:1
Verif.	M.Z.	Date	12-12-2011	Dis.	M.Z.
				Date	12-12-2011
				Codice Dis.N°	A6868D22.256

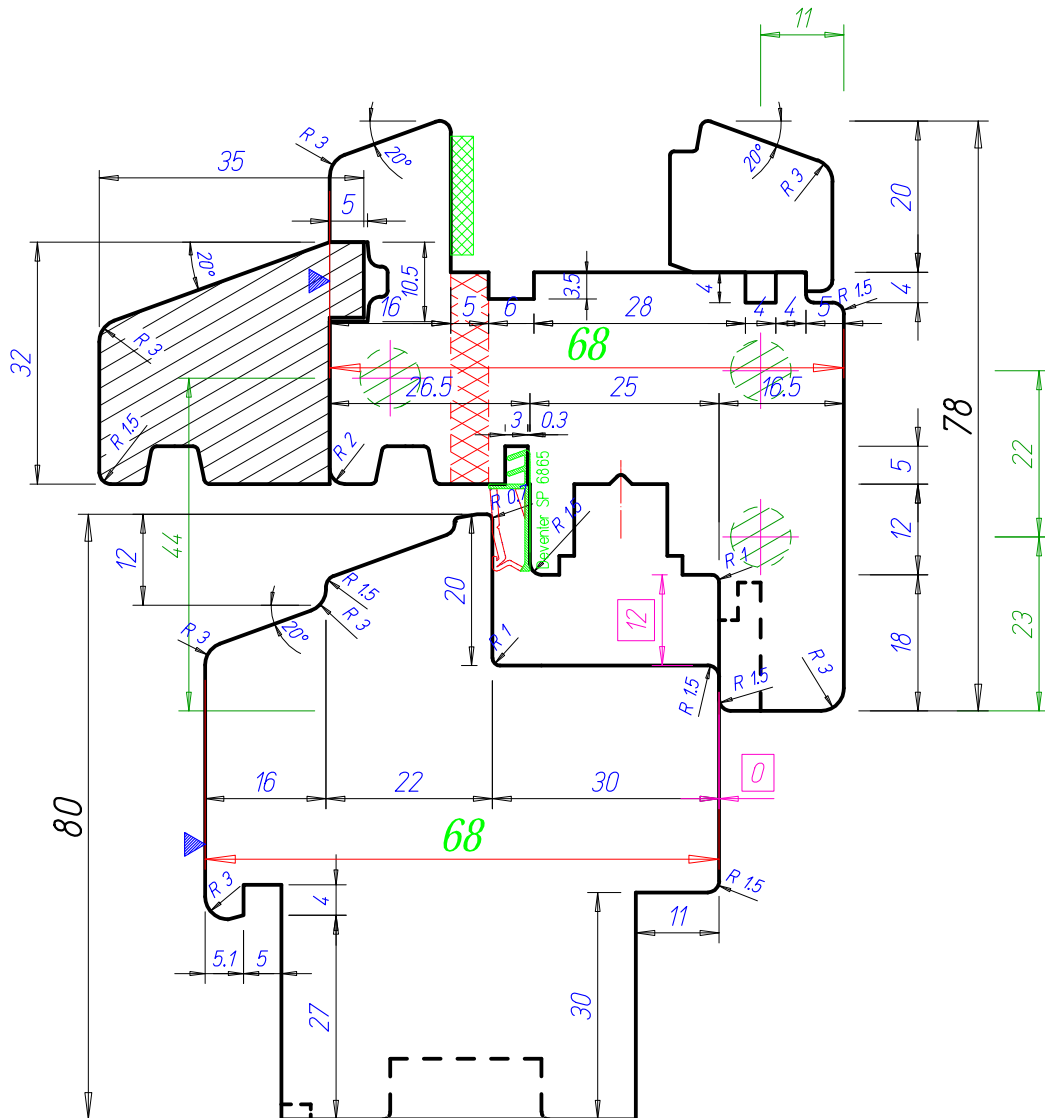
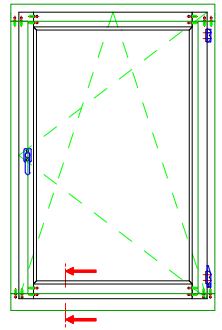

AUFLAGESEITE

SENKRECHTER SCHNITT unten DENKMAL

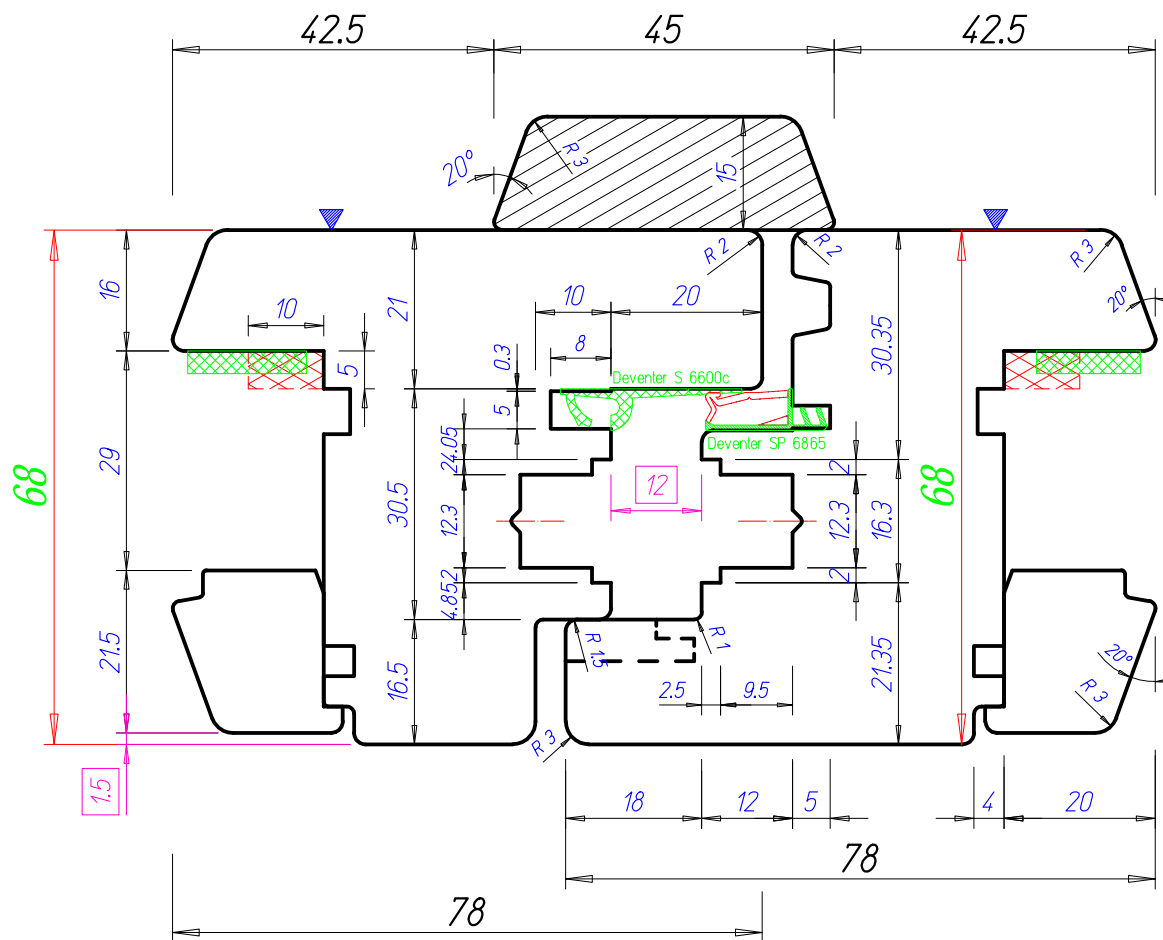
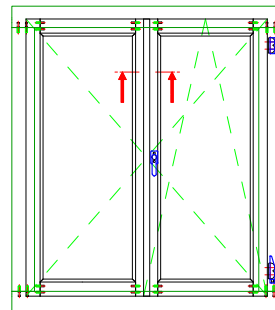

AUFLAGESEITE

WAAGERECHTER SCHNITT - Mittelfalz ohne Überfälzung

Kunde		ZUANI DEUTSCHLAND rif. PAULI			
Title		Fensterschnitt IV 68/68 - Eurofalz Achsmass 13 mm			
Revis.	A.P.	Date	15-05-2012	Scala	1:1
Verif.	M.Z.	Date	12-12-2011	Dis.	M.Z.
				Codice Dis.N°	A6868D22.256
				Date	12-12-2011

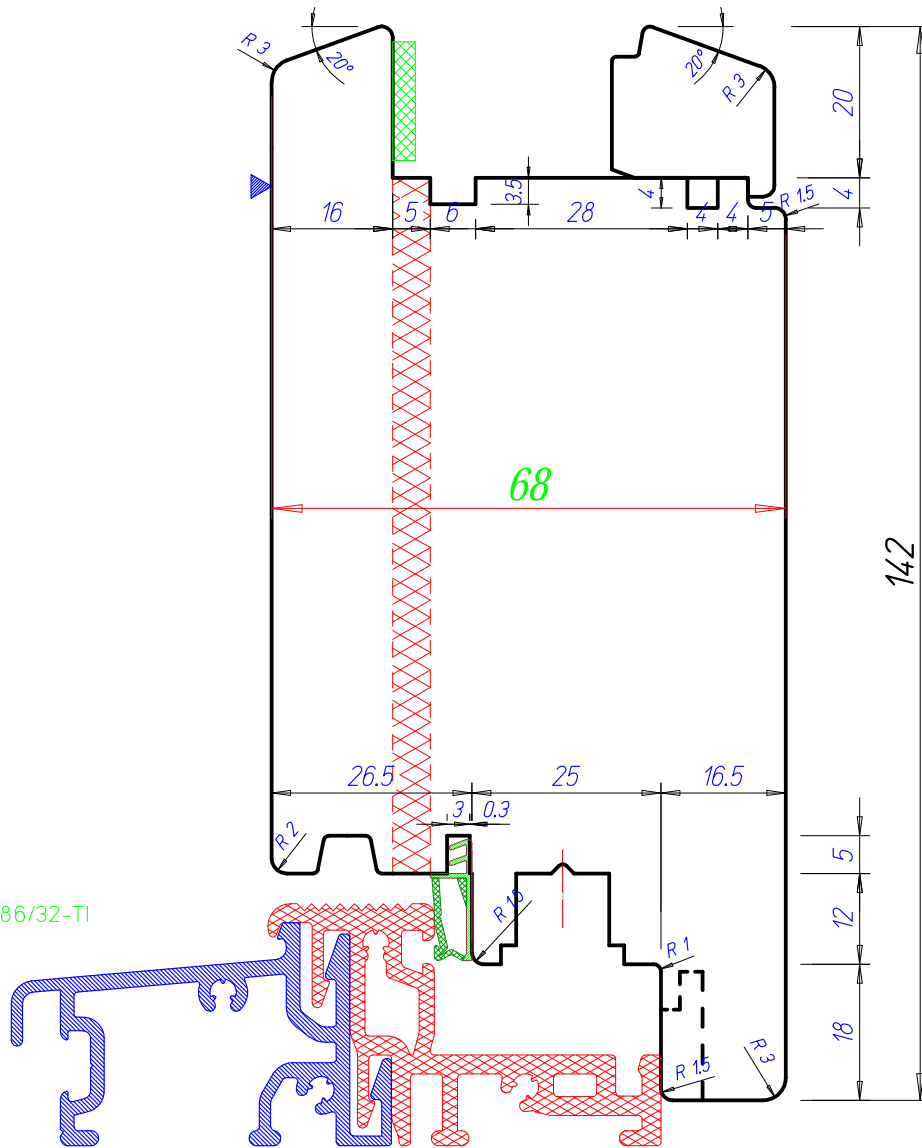
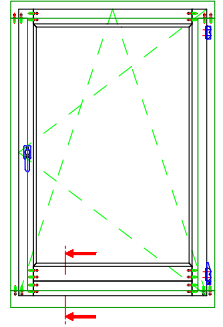

Bodenschwelle
GUTMANN Weser 86/32-TI

AUFLAGESEITE

BALKONTÜR - SENKRECHTER SCHNITT UNTEN

Kunde		ZUANI DEUTSCHLAND rif. PAULI			
Title		Fensterschnitt IV 68/68 - Eurofalz Achsmass 13 mm			
Revis.	A.P.	Date	15-05-2012	Scala	1:1
Verif.	M.Z.	Date	12-12-2011	Dis.	M.Z.
				Dis.N°	A6868D22.256

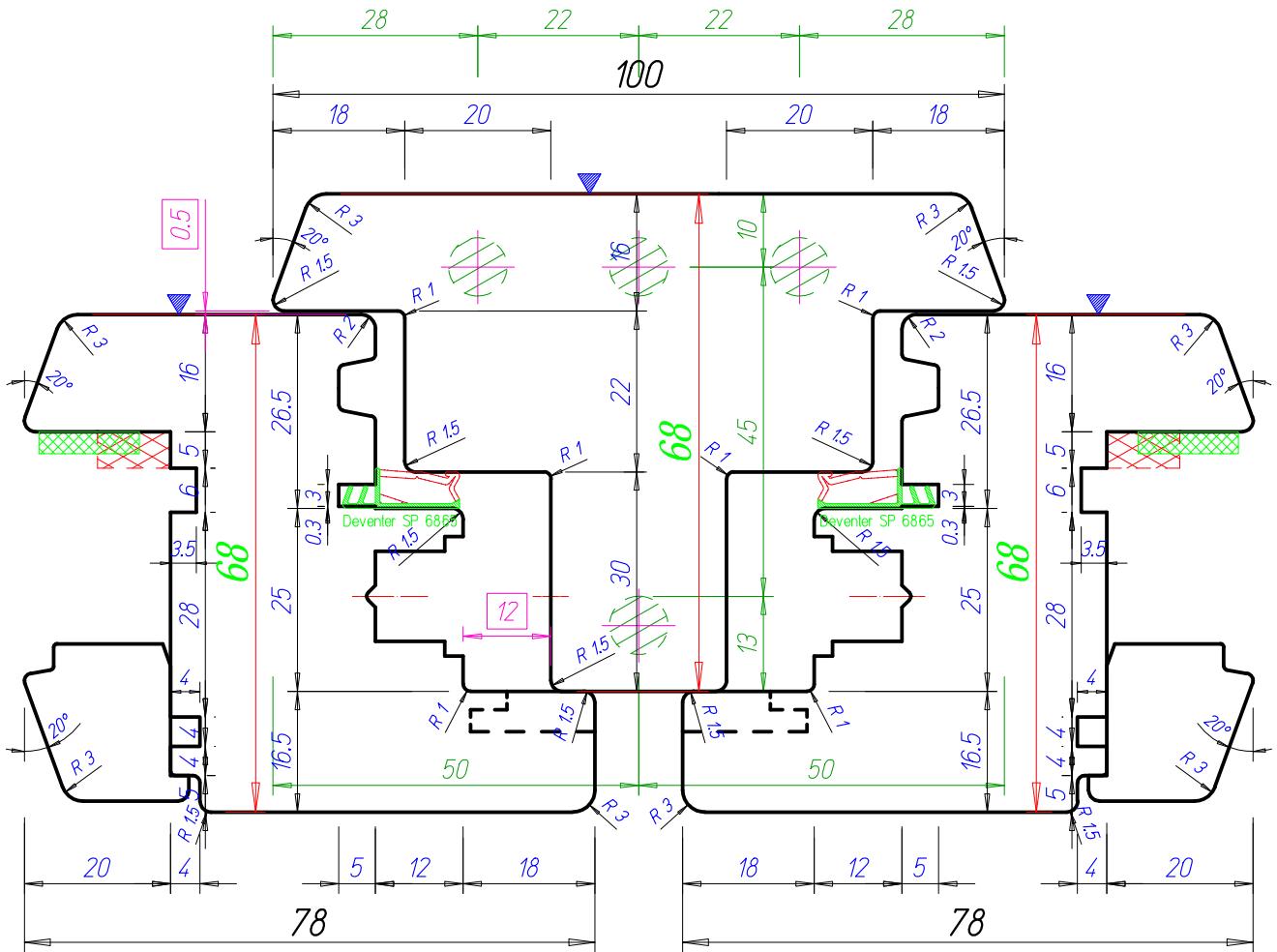
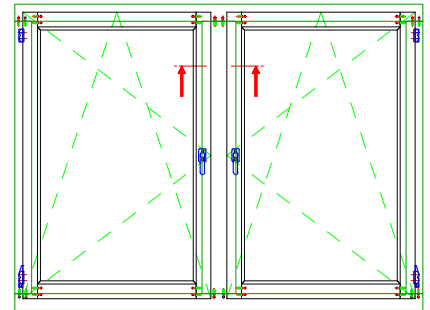

AUFLAGESEITE

WAAGERECHTER SCHNITT - SETZHOLZ

Kunde		ZUANI DEUTSCHLAND rif. PAULI			
Title		Fensterschnitt IV 68/68 - Eurofalz Achsmass 13 mm			
Revis.	A.P.	Date	15-05-2012	Scala	1:1
Verif.	M.Z.	Date	12-12-2011	Dis.	M.Z.
				Codice	
				Dis.N°	A6868D22.256

Gutmann
Spree OF 24

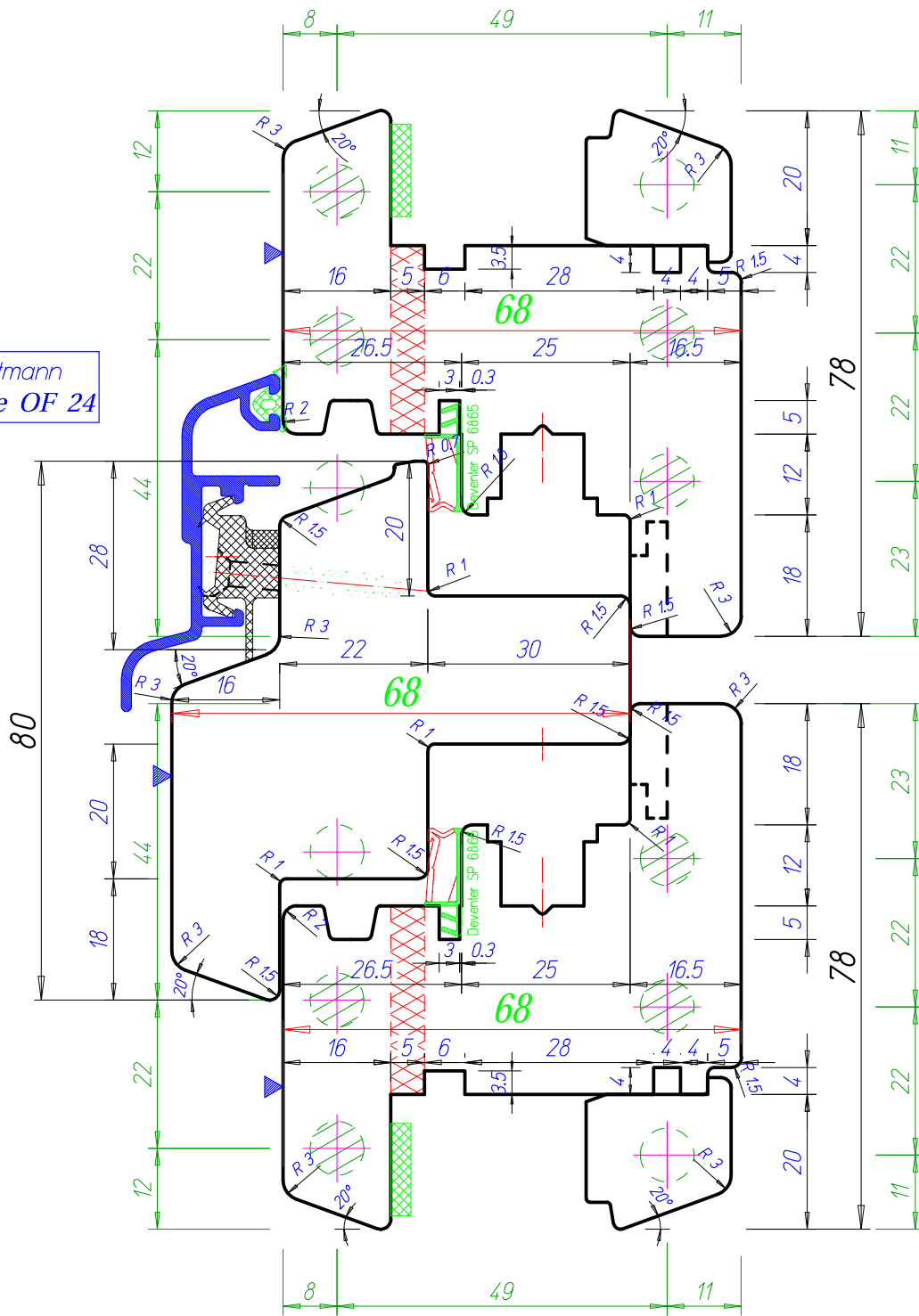

AUFLAGESEITE

SENKRECHTER SCHNITT - KÄMPFER

Kunde		ZUANI DEUTSCHLAND rif. PAULI			
Title		Fensterschnitt IV 68/68 - Eurofalz Achsmass 13 mm			
Revis.	A.P.	Date	15-05-2012	Scala	1:1
Verif.	M.Z.	Date	12-12-2011	Dis.	M.Z.
				Codice Dis.N°	A6868D22.256
				Date	12-12-2011

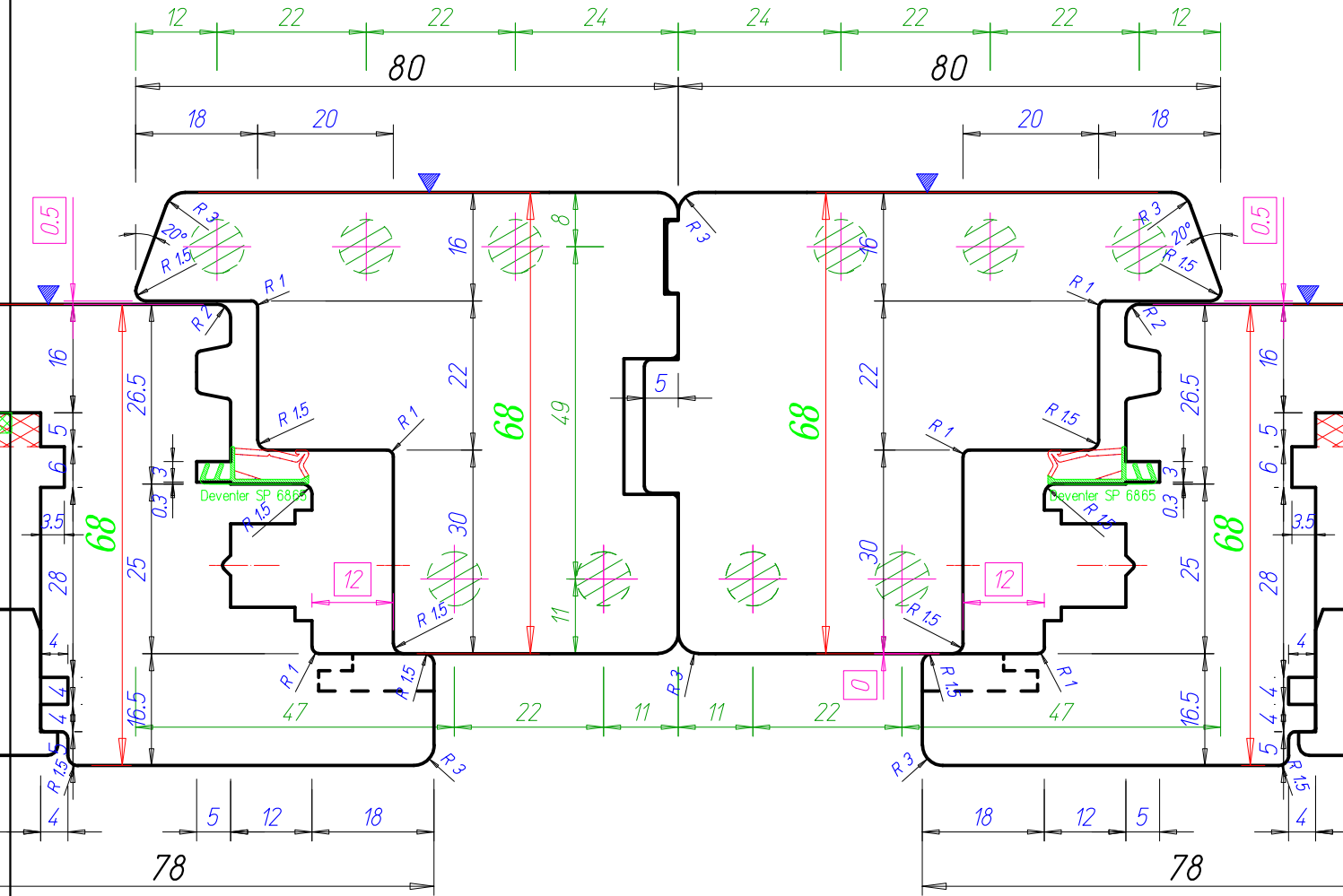
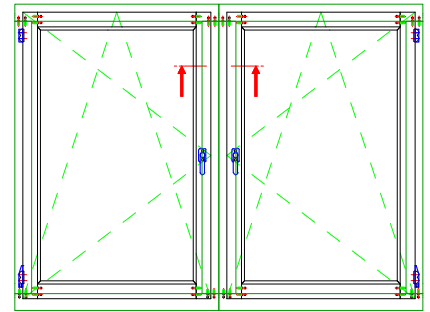

AUFLAGESEITE

WAAGERECHTER SCHNITT - SETZHOLZ

Kunde		ZUANI DEUTSCHLAND rif. PAULI			
Title		Fensterschnitt IV 68/68 - Eurofalz Achsmass 13 mm			
Revis.	A.P.	Date	15-05-2012	Scala	1:1
Verif.	M.Z.	Date	12-12-2011	Dis.	M.Z.
				Codice Dis.N°	A6868D22.256

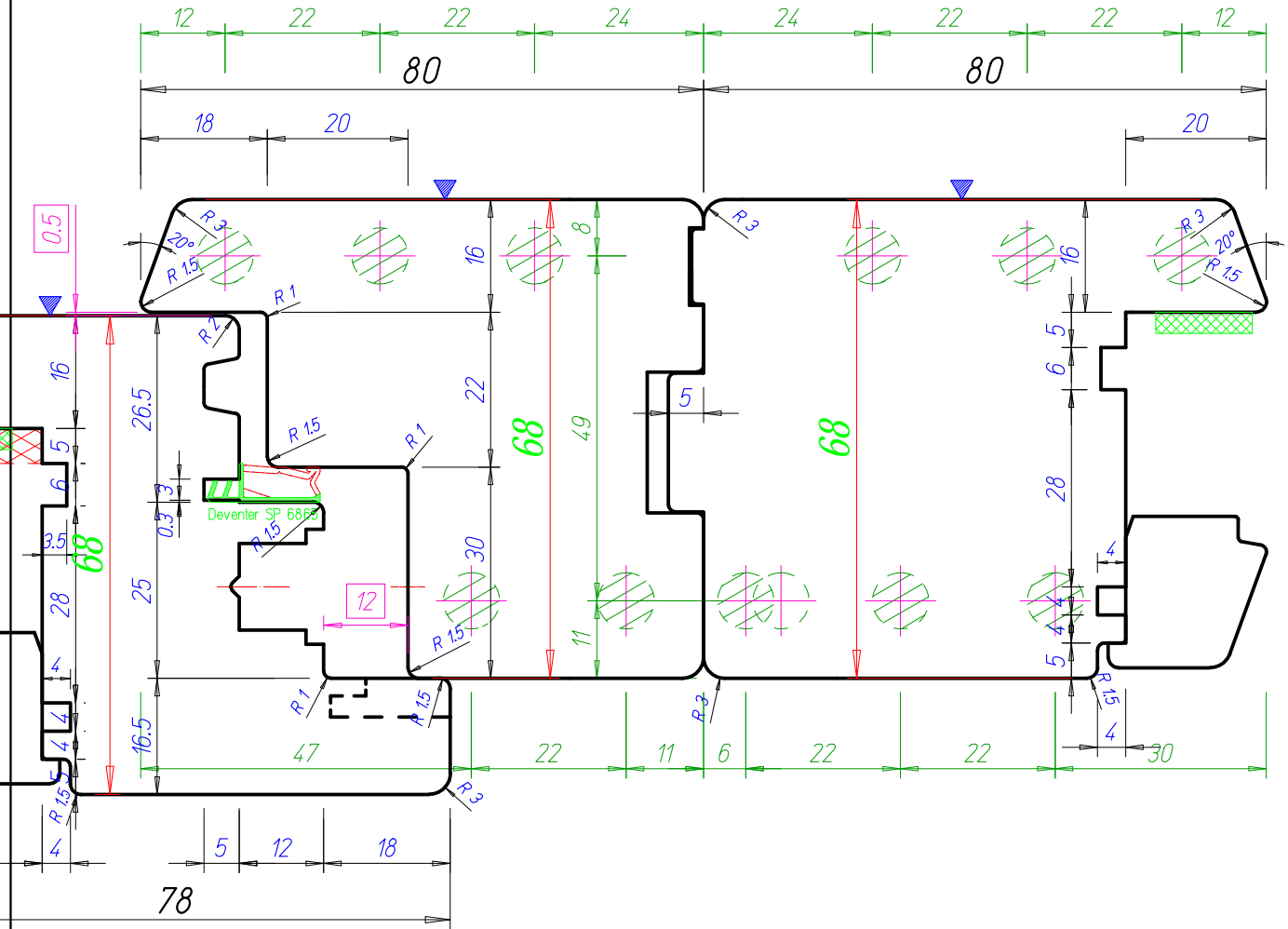
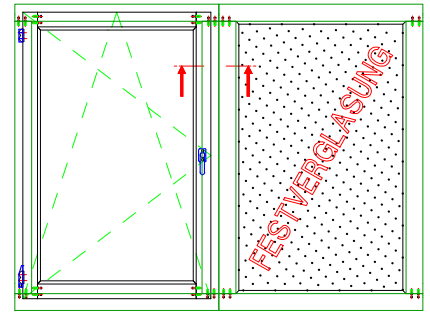

 AUFLAGESEITE

WAAGERECHTER SCHNITT - SETZHOLZ

Kunde		ZUANI DEUTSCHLAND rif. PAULI			
Title		Fensterschnitt IV 68/68 - Eurofalz Achsmass 13 mm			
Revis.	A.P.	Date	15-05-2012	Scala	1:1
Verif.	M.Z.	Date	12-12-2011	Dis.	M.Z.
		Codice Dis.N°	A6868D22.256		
		Date	12-12-2011		

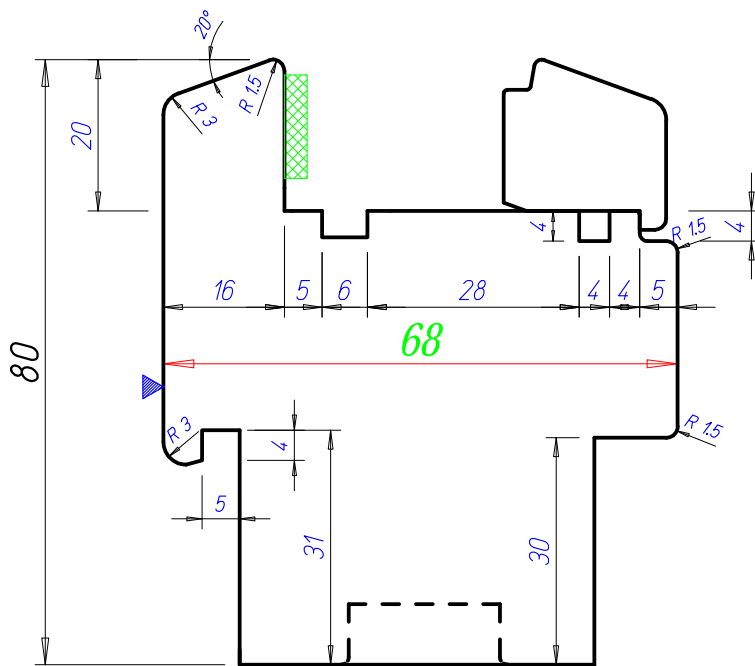
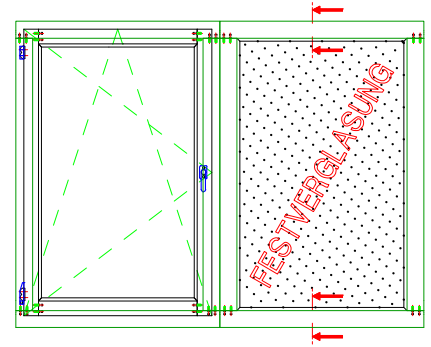
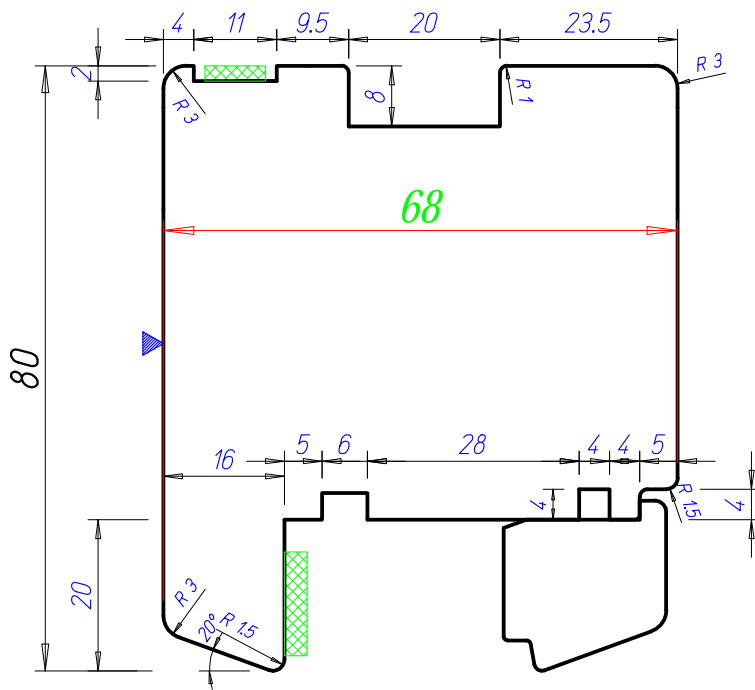

 AUFLAGESEITE

SENKRECHTER SCHNITT - SETZHOLZ

Kunde		ZUANI DEUTSCHLAND rif. PAULI			
Title		Fensterschnitt IV 68/68 - Eurofalz Achsmass 13 mm			
Revis.	A.P.	Date	15-05-2012	Scala	1:1
Verif.	M.Z.	Date	12-12-2011	Dis.	M.Z.
		Date	12-12-2011	Codice	
				Dis.N°	A6868D22.256

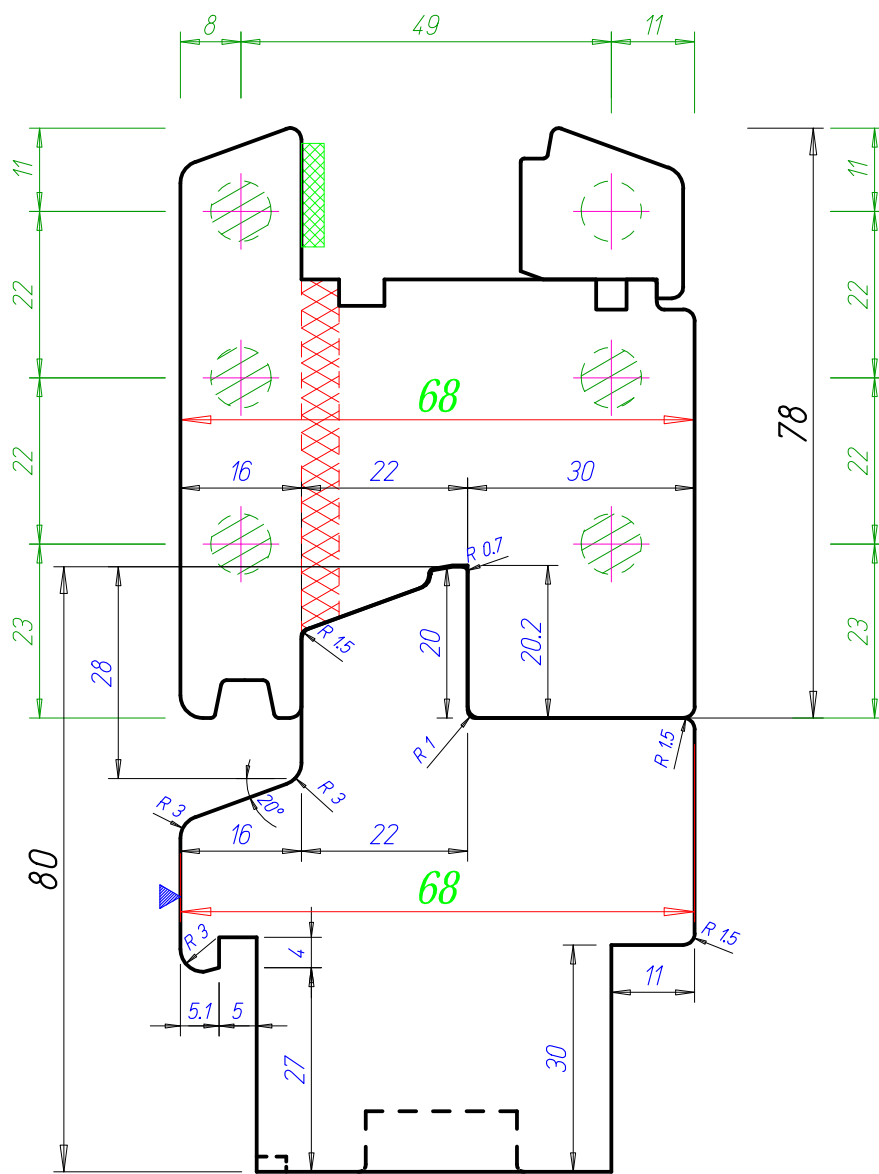
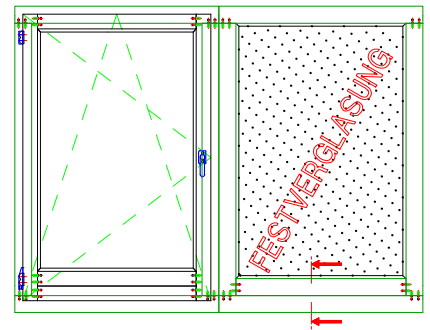
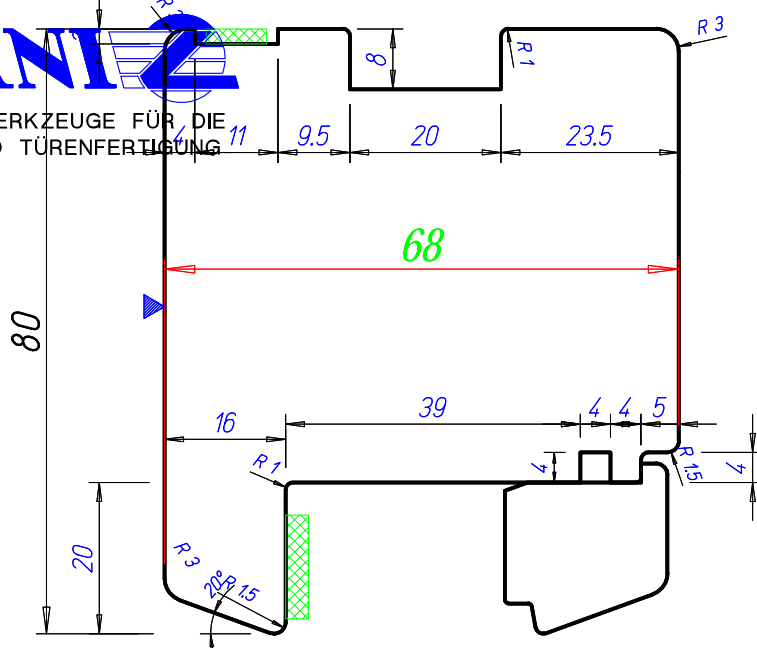

AUFLAGESEITE

SENKRECHTER SCHNITT - SETZHOLZ

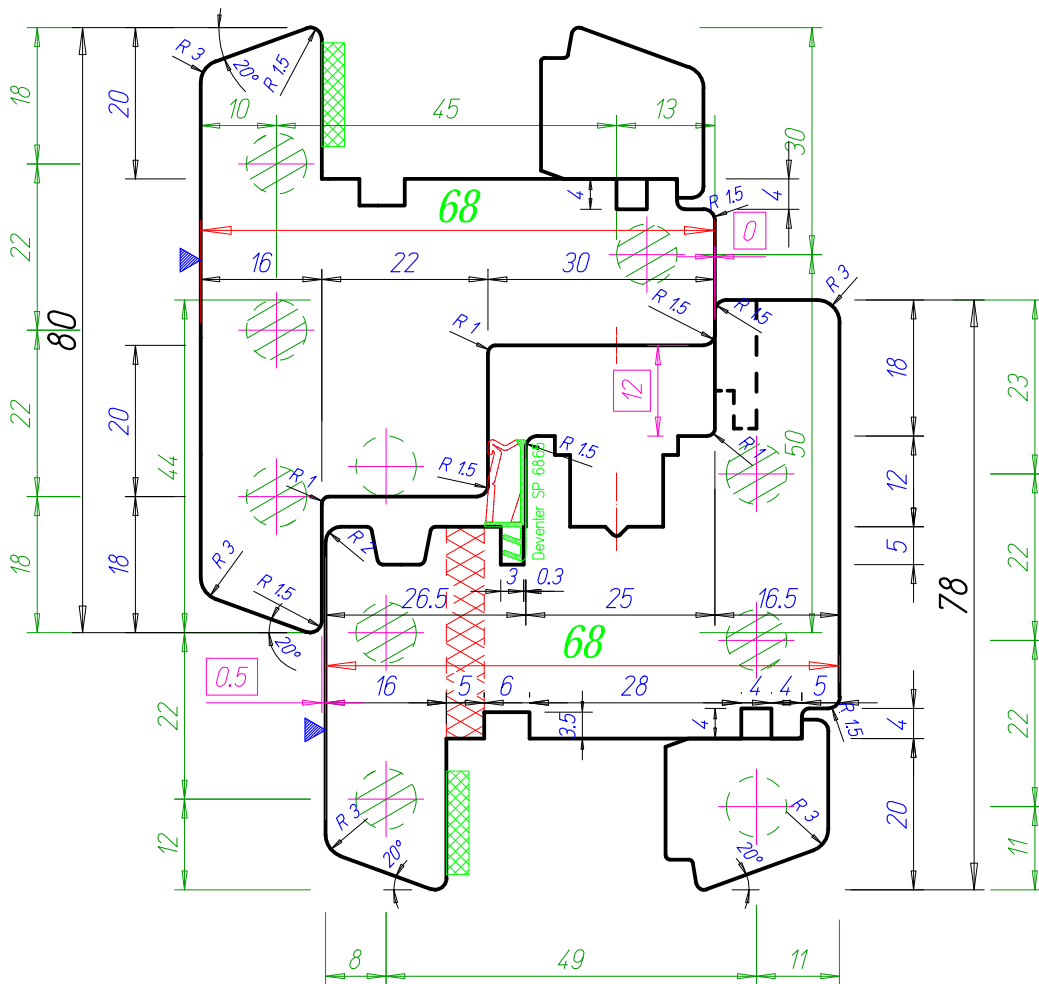
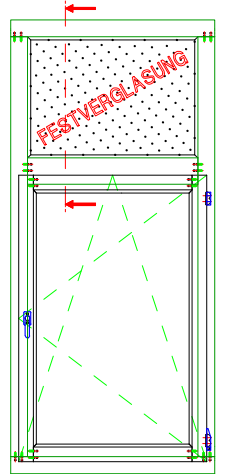
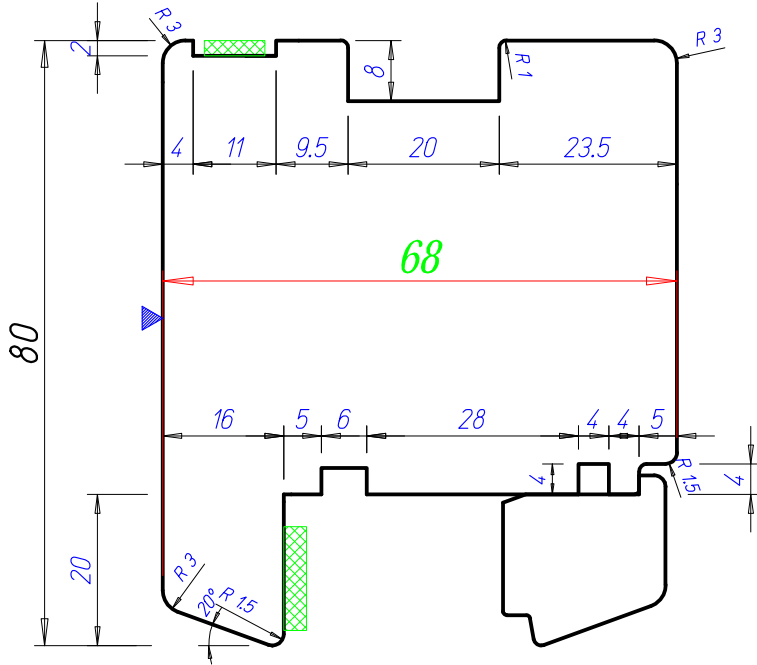

 AUFLAGESEITE

SENKRECHTER SCHNITT - ÜBERLICHT

Kunde		ZUANI DEUTSCHLAND rif. PAULI			
Title		Fensterschnitt IV 68/68 - Eurofalz Achsmass 13 mm			
Revis.	A.P.	Date	15-05-2012	Scala	1:1
Verif.	M.Z.	Date	12-12-2011	Dis.	M.Z.
		Date	12-12-2011	Codice	M.Z.
				Dis.N°	A6868D22.256

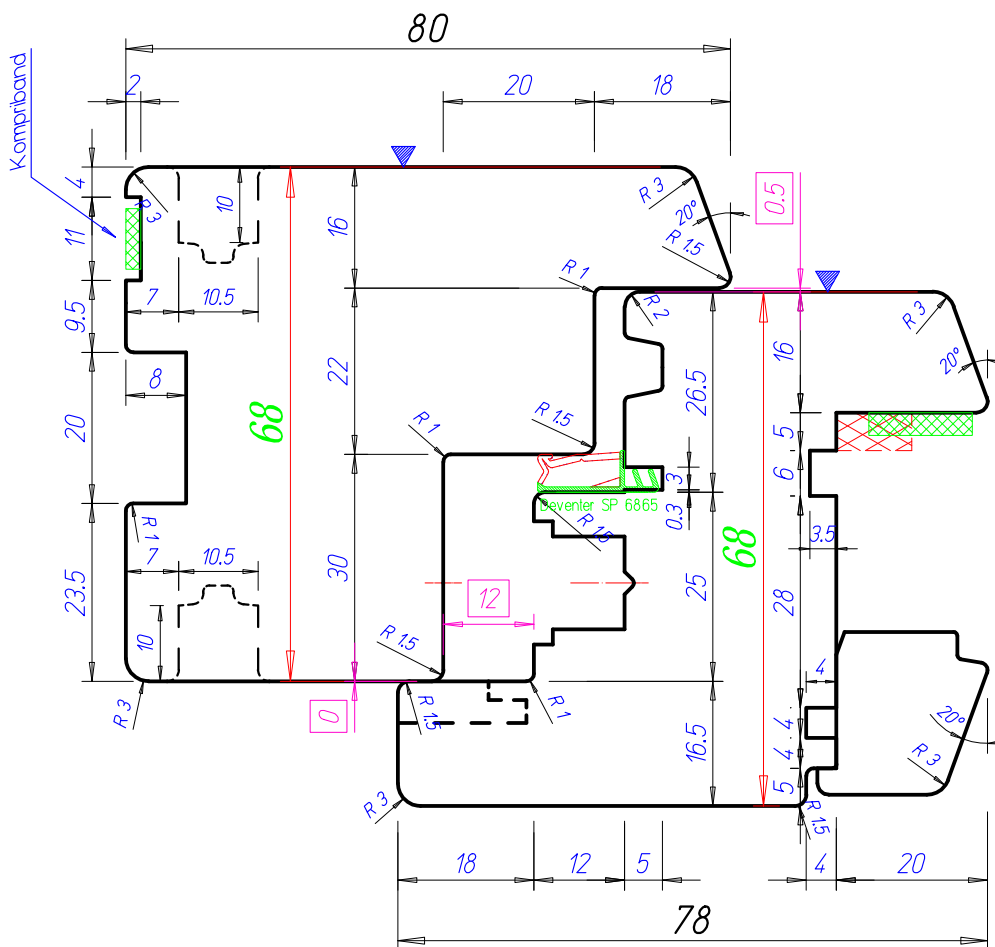
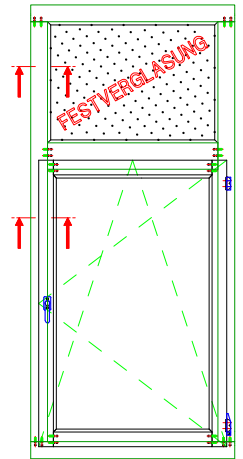
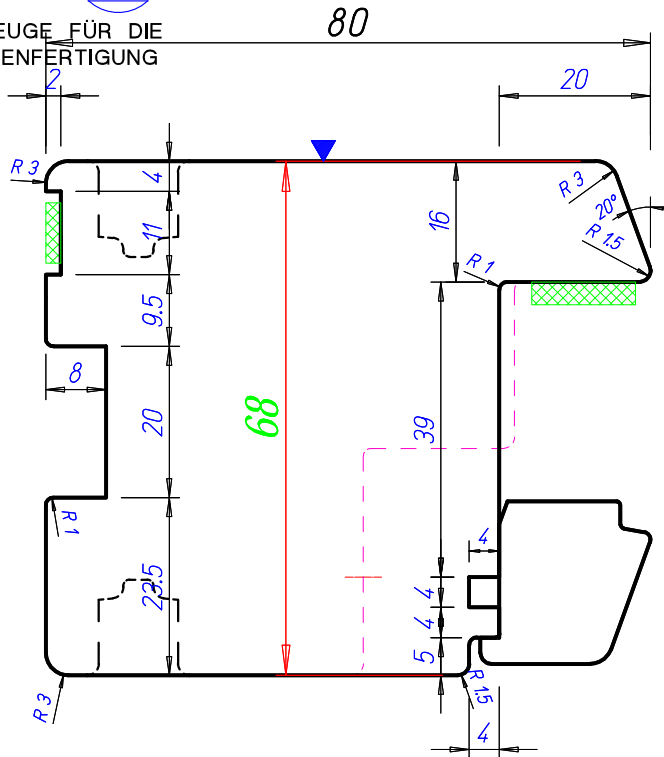

AUFLAGESEITE

WAAGERECHTER SCHNITT - ÜBERLICHT

Kunde		ZUANI DEUTSCHLAND rif. PAULI			
Title Fensterschnitt IV 68/68 - Eurofalz Achsmass 13 mm					
Revis.	A.P.	Date	15-05-2012	Scala	1:1
Verif.	M.Z.	Date	12-12-2011	Dis.	M.Z.
				Dis.N°	12-12-2011
				Codice	A6868D22.256
				Dis.N°	12-12-2011

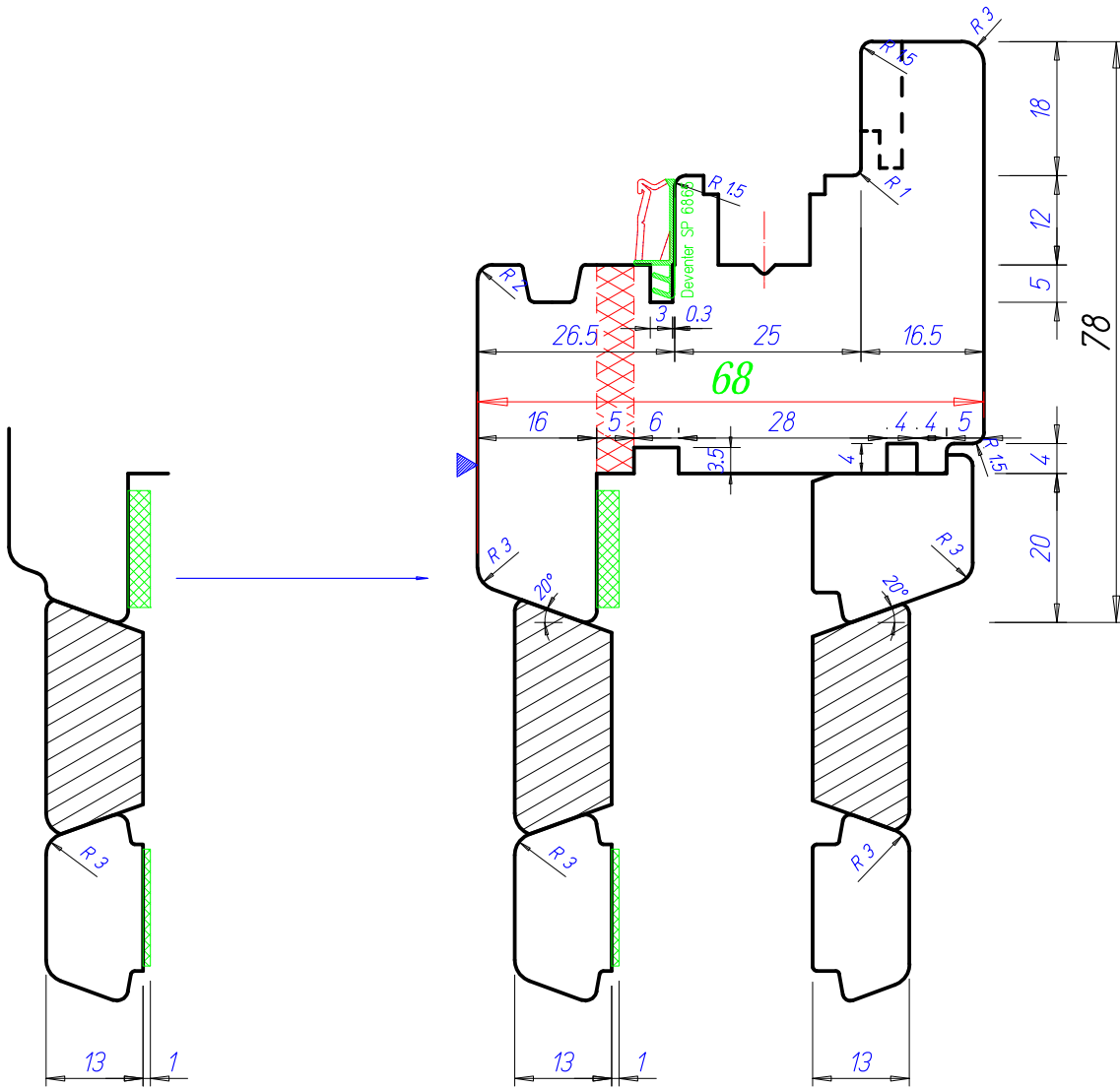
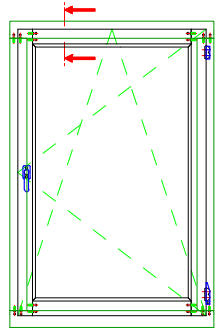

AUFLAGESEITE

SENKRECHTER SCHNITT - SPROSSEN